

Stock management system modification Specifications Documentation EN Blueprint for SMPT Blueprint

R6

Made for: Sanko Mold and Plastics (Thailand) Co., Ltd.
By: TOMAS TECH CO.,LTD.







TOMAS TECH



TOMAS TECH CO.,LTD.

7/1 (3C) Udomsuk 46 Alley, Khwaeng Bang Na, Khet Bang Na, Bangkok 10260 Thailand
Tel :+66-98-271-9741 E-mail : info@tomastc.com

Revision History

Date	Version	File name	Details
26/Jun/2023	R1	Stock management system Specifications Documentation EN Blueprint for SMPT Blueprint	First edition
19/Jul/2023	R2	Stock management system Specifications Documentation EN Blueprint for SMPT Blueprint	Second edition 
4/Aug/2023	R3	Stock management system Specifications Documentation EN Blueprint for SMPT Blueprint	Third edition 
19/Aug/2023	R4	Stock management system Specifications Documentation EN Blueprint for SMPT Blueprint	Fourth edition 
25/Aug/2023	R5	Stock management system Specifications Documentation EN Blueprint for SMPT Blueprint	fifth edition 
20/Sep/2023	R6	Stock management system Specifications Documentation EN Blueprint for SMPT Blueprint	Sixth edition 

■ Contents

1. Overview
2. Overall configuration diagram
3. Document image
4. System functional specifications
 - 4-1. Warehouse Inbound 
 - 4-1-1. Simple Inbound
 - 4-1-2. Inbound handy terminal function (Adjust the quantity)
 - 4-2. Warehouse Outbound 
 - 4-2-1. Simple Outbound
 - 4-2-2. Outbound handy terminal function (Adjust the quantity)
5. Configuration file storage
 - 5-1-1. Stock card Record xlsx data
 - 5-1-2. Stock card export (xlsx) function
 - 5-2-1. Stock control vision monitor 
6. Web config
 - 6-1. Calendar
 - 6-2. Forecast master & Standard packing master
7. Q&A
8. Sign off

1. Overview

We propose an inventory management system to SMPT. In the current operation, we aim to improve work efficiency and work accuracy by replacing the work managed by paper and whiteboard with a system.

The expected effects of introducing an inventory management system are as follows.

1. By managing the ordering points, it is possible to eliminate excess inventory and out-of-stock.
2. Managing the product location can solve the overflow problem. In addition, it is possible to thoroughly implement the FIFO.
3. Work efficiency and work accuracy can be improved by supporting work at the handy terminal at the time of warehousing and warehousing.

2. Overall configuration diagram

Represents a configuration diagram of the Stock management system. It is a configuration image of hardware and documents.

Overall configuration diagram image

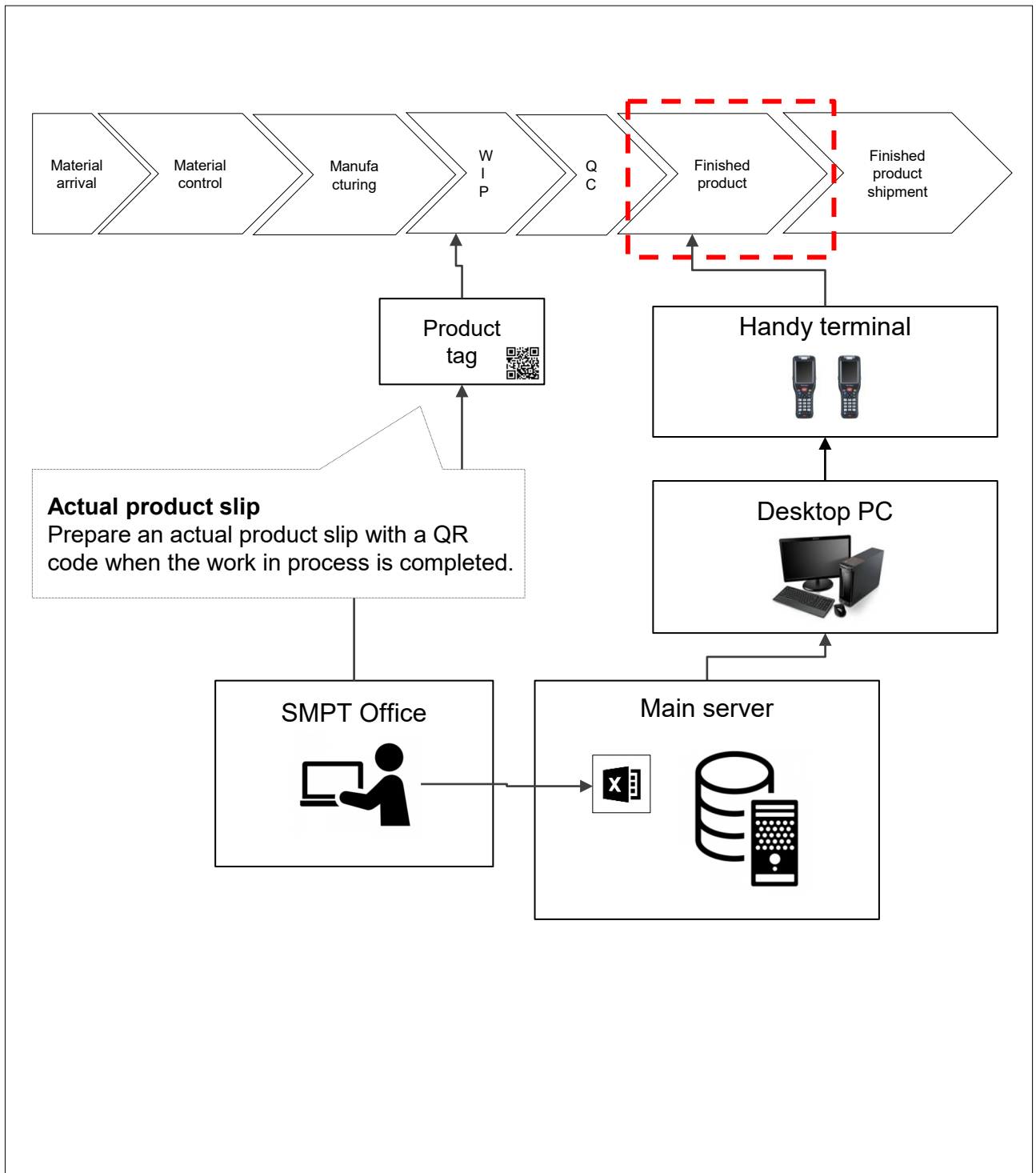

2. Overall configuration diagram

Network diagram

#	Item	Qty	IP adress	Preparation
1	Main server	1		SMPT
2	Desktop PC	1		SMPT
3	Staff PC	1		SMPT
4	Switching hub	2		SMPT
5	Handy terminal #1	1		Tomas
6	Handy terminal #2	1		Tomas

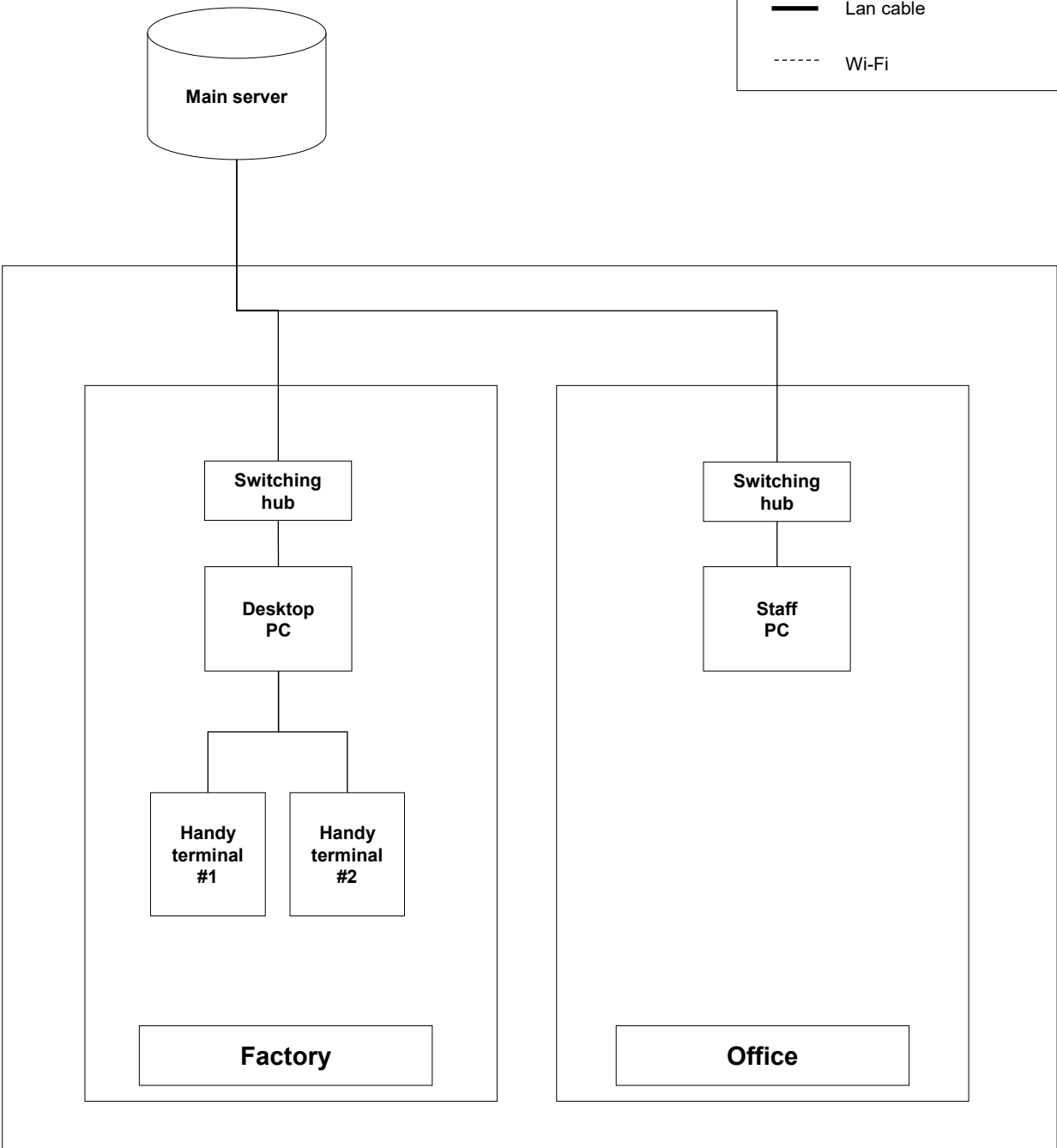
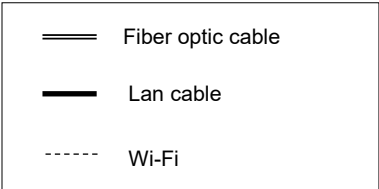

3. Document image

Describe the documents required to operate the Stock management system.

3-1. Product tag

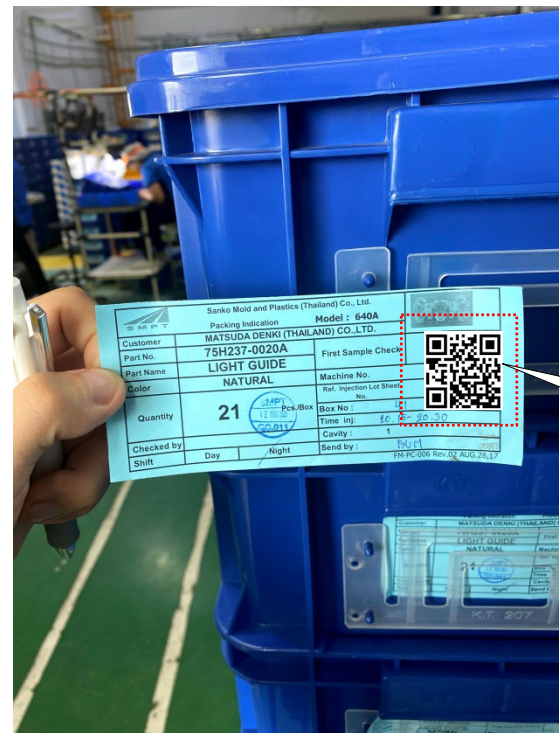

Sanko Mold and Plastics (Thailand) Co., Ltd.		
Packing Indication		Model : 338B
Customer	TOKAI RIKI (THAILAND) CO., LTD	
Part No.	61E469-0012	First Sample Check
Part Name	CASE INNER A	
Color	Black	Machine No. B
Quantity	200	Pcs./Box
Checked by		Ref. Injection Lot Sheet No.
Shift	Day	Night
		Box No :
		Time inj:
		Cavity : 1
		Send by :

Add customer data to QRCode tag label

3-2. Stock card Record

Sanko Mold and Plastics (Thailand) Co., Ltd.		Stock Card Record TRT For 2023	
No.	Part No.	Part Name	Pcs./Box
1	102012-0040A	LIGHT GUIDE	1200
2	75H237-0020A	LIGHT GUIDE	5000
3	102034-0030B	Body LENS	500
4	102034-0041	Cover	100
5	61E469-0001	Case Inner A	200
6	61E469-0002	Case Inner B	200
7	102037-0010	HOLDER	200
8	624888-0020	CASE	132
9	624888-0033	LID	200
10	624734-0020	LID	200
11	624734-0030	Case	132
12	172198-0031	Bracket Turn Rev	140
13	172198-0040	Case Middle Turn Rev	140

3. Document image

Describe the documents required to operate the Stock management system.

3-3. Stock Card Board



Finish Goods Delivery Condition & Stock Control Vis																						
No.	Description	Product Name	How to Order Qty	Maximum Order Qty	Minimum Order Qty	Status Of delivery															Total Qty	Inventory
						1	2	3	4	5	6	7	8	9	10	11	12	13	14	15		
141	1000000000	1000000000	4000	7500	500															4000	155	
142	1000000000	1000000000	4000	7500	500															4000	155	
143	1000000000	1000000000	24675	36170	1200															24675	1005	
144	1000000000	1000000000	25000	32000	1000															25000	1005	
145	1000000000	1000000000	15000	17500	2000															15000	1005	
146	1000000000	1000000000	15000	17500	2000															15000	1005	
147	1000000000	1000000000	15000	17500	2000															15000	1005	
148	1000000000	1000000000	15000	17500	2000															15000	1005	
149	1000000000	1000000000	15000	17500	2000															15000	1005	
150	1000000000	1000000000	15000	17500	2000															15000	1005	
151	1000000000	1000000000	15000	17500	2000															15000	1005	
152	1000000000	1000000000	15000	17500	2000															15000	1005	
153	1000000000	1000000000	15000	17500	2000															15000	1005	
154	1000000000	1000000000	15000	17500	2000															15000	1005	
155	1000000000	1000000000	15000	17500	2000															15000	1005	
156	1000000000	1000000000	15000	17500	2000															15000	1005	
157	1000000000	1000000000	15000	17500	2000															15000	1005	
158	1000000000	1000000000	15000	17500	2000															15000	1005	
159	1000000000	1000000000	15000	17500	2000															15000	1005	
160	1000000000	1000000000	15000	17500	2000															15000	1005	
161	1000000000	1000000000	15000	17500	2000															15000	1005	
162	1000000000	1000000000	15000	17500	2000															15000	1005	
163	1000000000	1000000000	15000	17500	2000															15000	1005	
164	1000000000	1000000000	15000	17500	2000															15000	1005	
165	1000000000	1000000000	15000	17500	2000															15000	1005	
166	1000000000	1000000000	15000	17500	2000															15000	1005	
167	1000000000	1000000000	15000	17500	2000															15000	1005	
168	1000000000	1000000000	15000	17500	2000															15000	1005	
169	1000000000	1000000000	15000	17500	2000															15000	1005	
170	1000000000	1000000000	15000	17500	2000															15000	1005	
171	1000000000	1000000000	15000	17500	2000															15000	1005	
172	1000000000	1000000000	15000	17500	2000															15000	1005	
173	1000000000	1000000000	15000	17500	2000															15000	1005	
174	1000000000	1000000000	15000	17500	2000															15000	1005	
175	1000000000	1000000000	15000	17500	2000															15000	1005	
176	1000000000	1000000000	15000	17500	2000															15000	1005	
177	1000000000	1000000000	15000	17500	2000															15000	1005	
178	1000000000	1000000000	15000	17500	2000															15000	1005	
179	1000000000	1000000000	15000	17500	2000															15000	1005	
180	1000000000	1000000000	15000	17500	2000															15000	1005	

4. System functional specifications

4-1. Warehouse Inbound

4-1-1. Inbound Handy terminal function

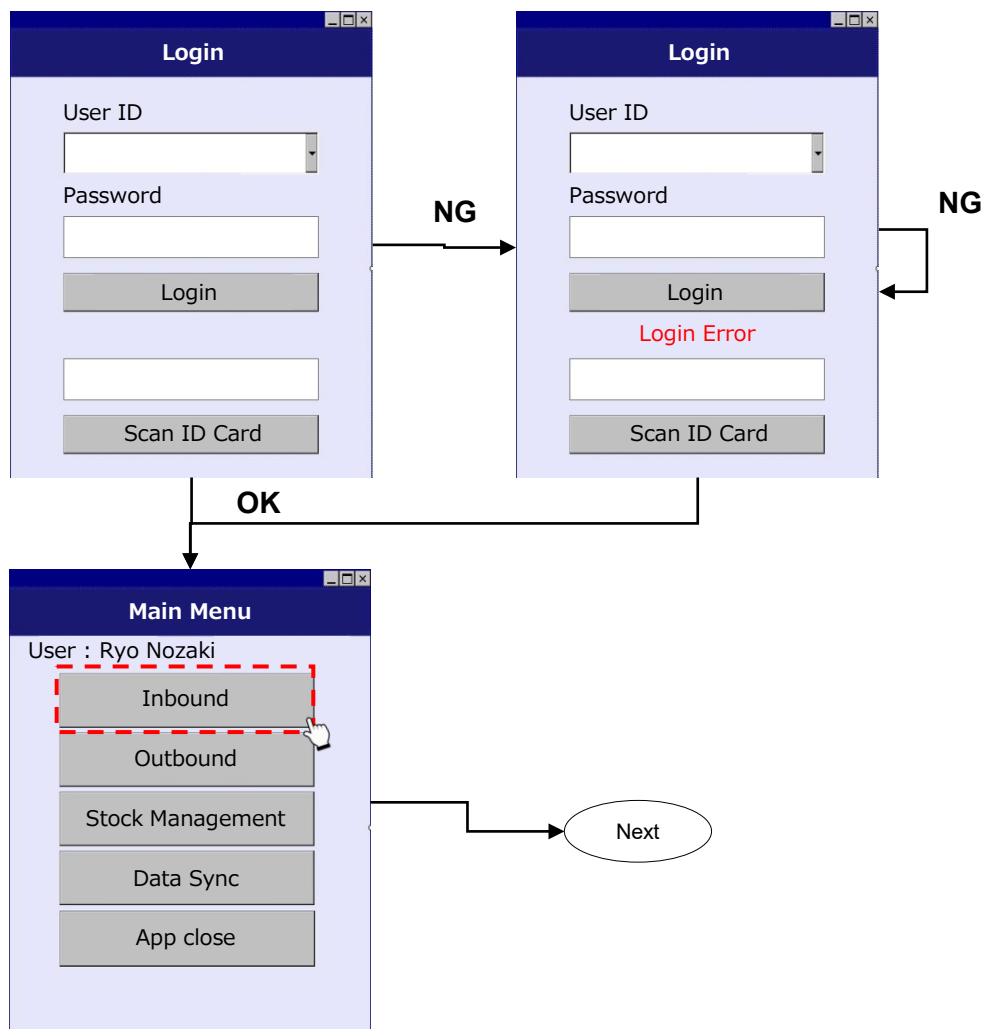

4. System functional specifications

4-1. Warehouse Inbound

4-1-1. Inbound Handy terminal function

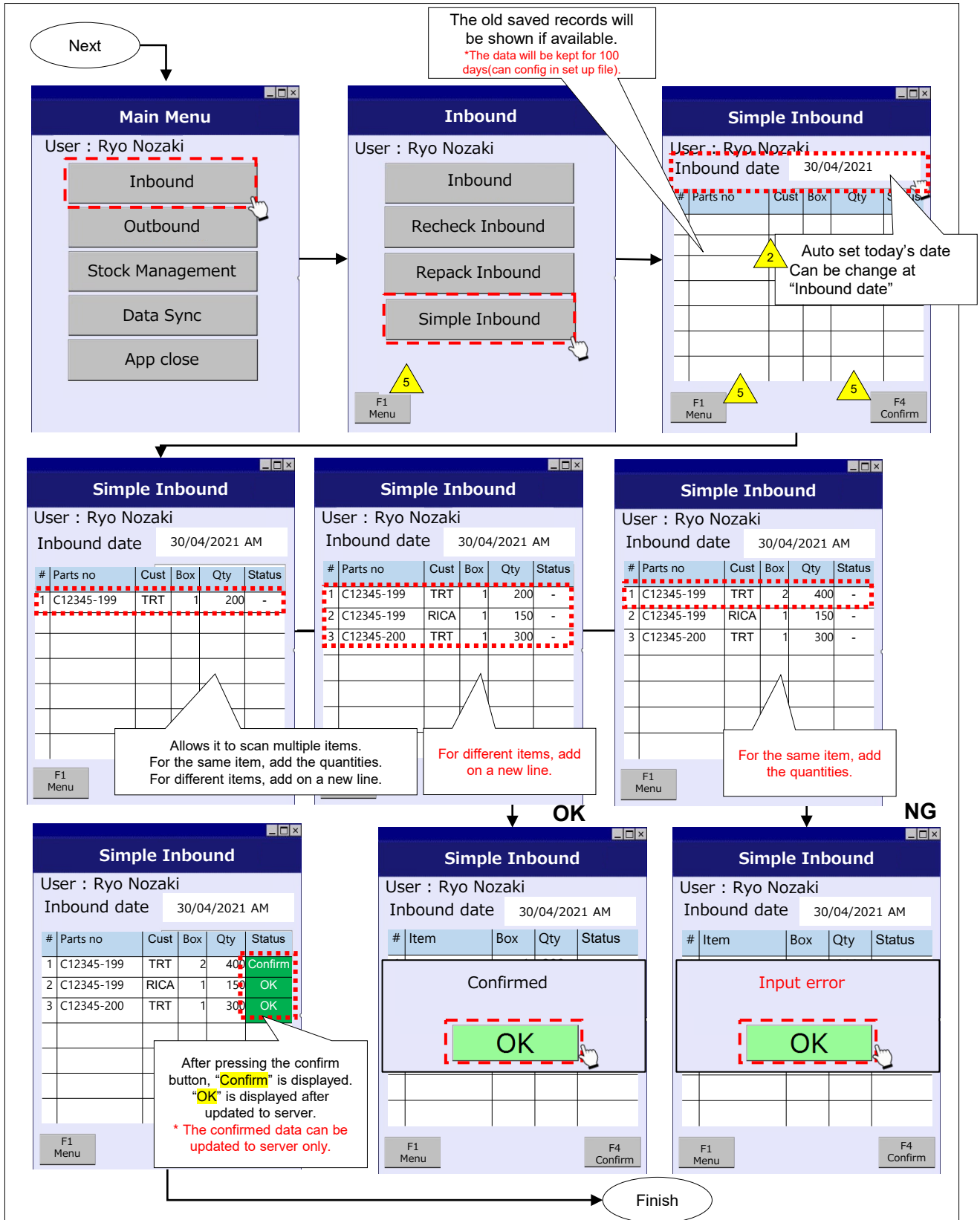

4. System functional specifications

4-1. Warehouse Inbound



4-1-2. Inbound Handy terminal function (Adjust the quantity)

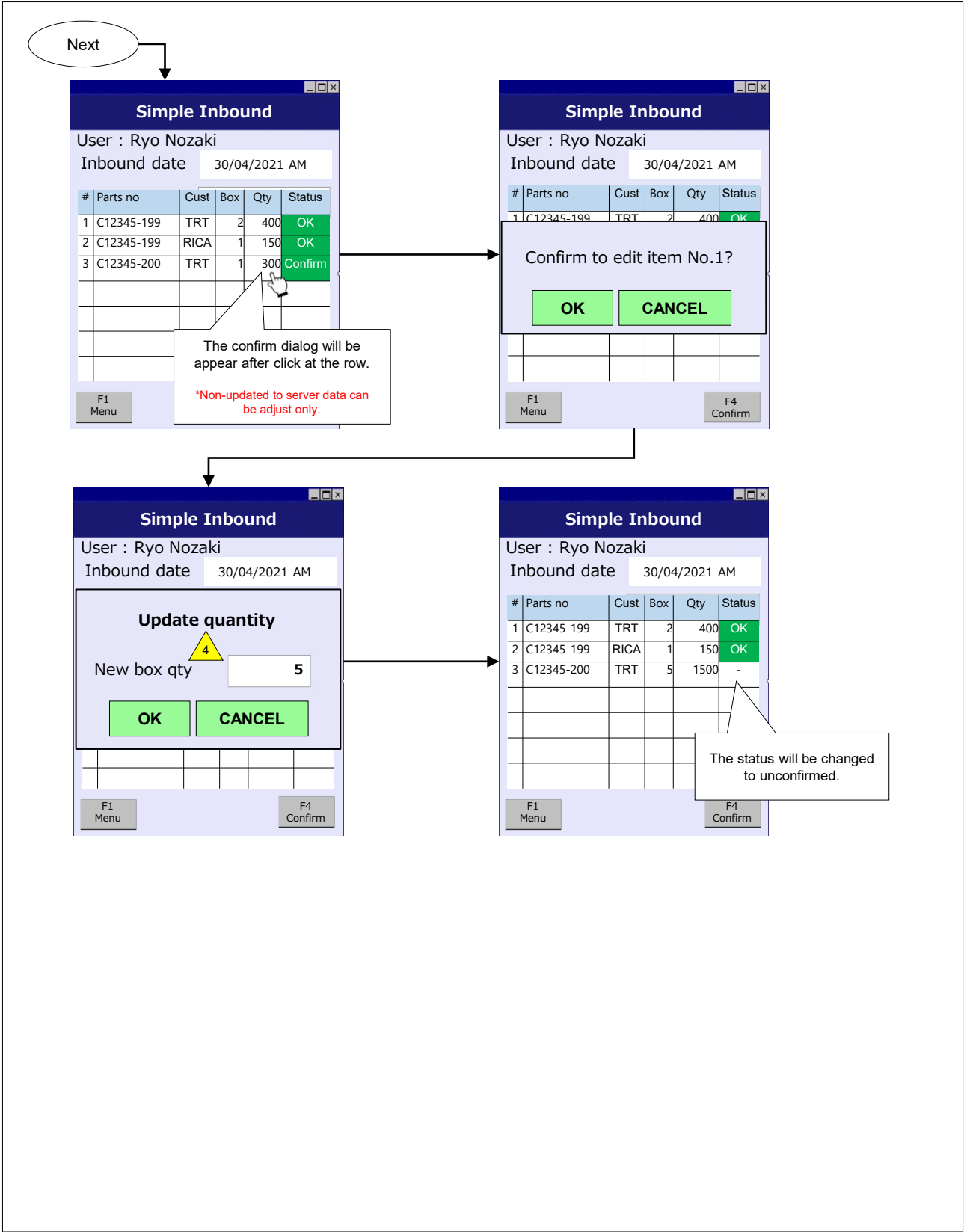

4. System functional specifications

4-2. Warehouse Outbound

4-2-1. Outbound Handy terminal function

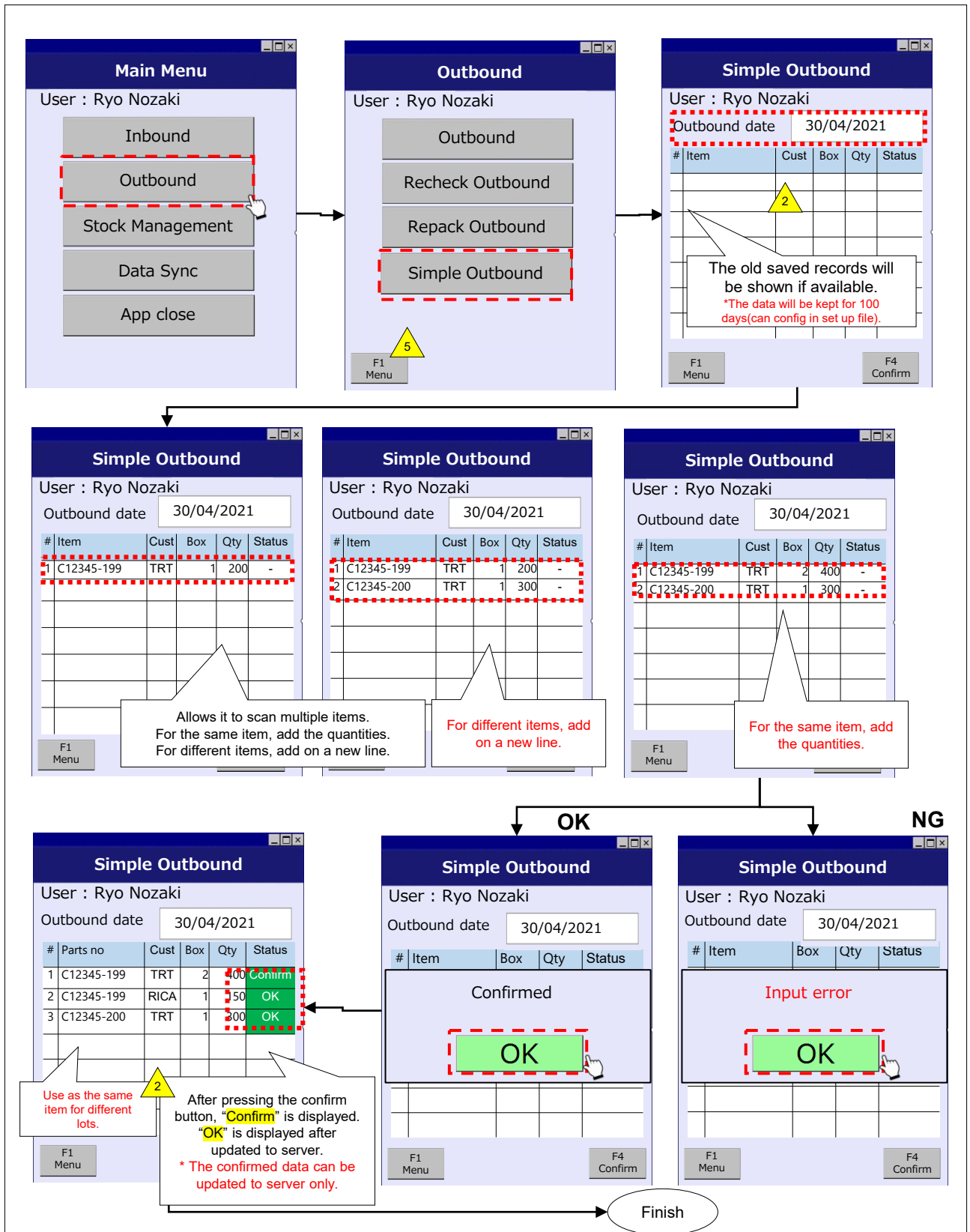

4. System functional specifications

4-1. Warehouse Outbound

4-2-2. Outbound Handy terminal function (Adjust the quantity)

2

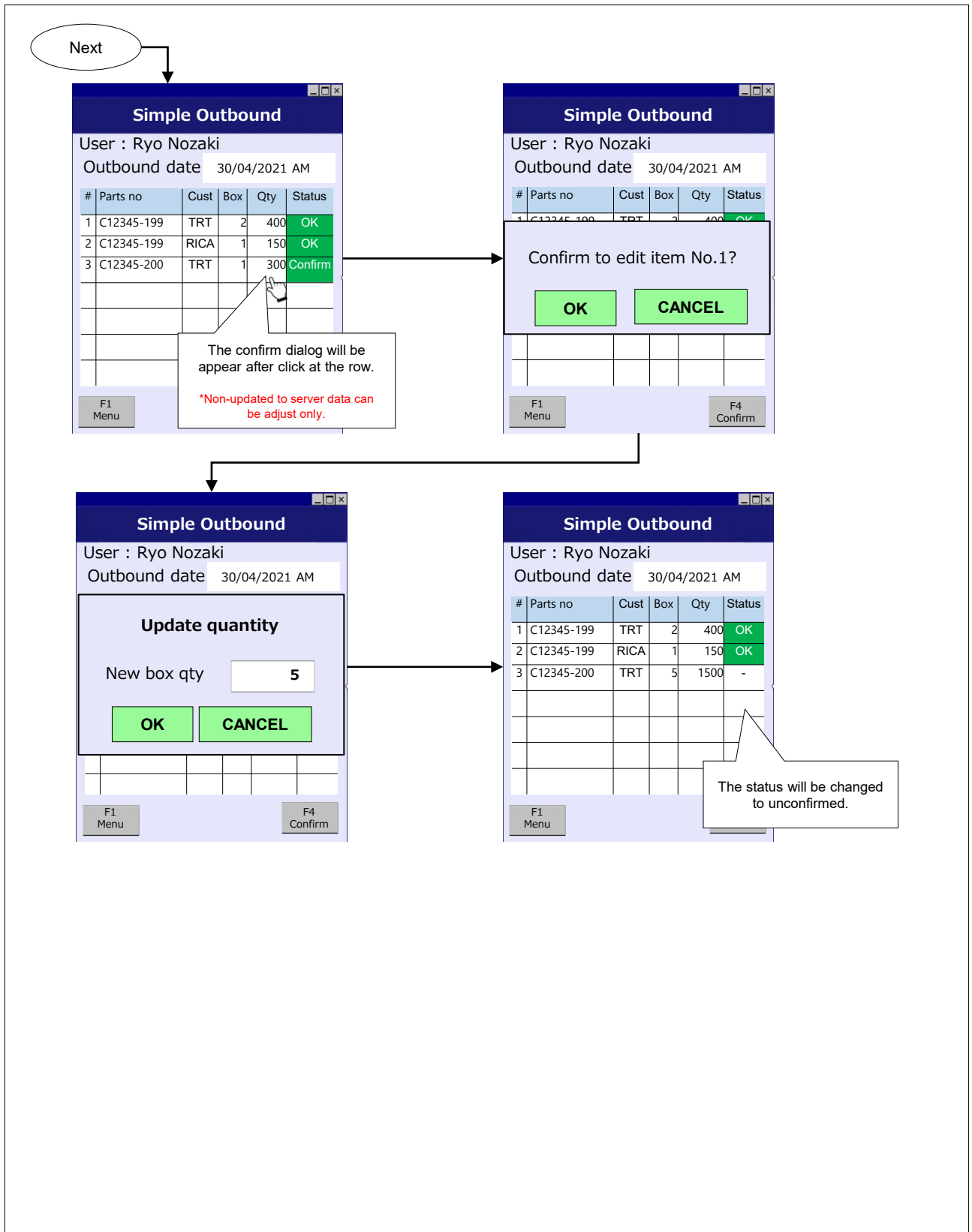

5. Configuration file storage

Output data:

5-1-1. Stock card Record xlsx data

Stock Card Record TRT For 2023

Issues:

1. Is it show the current data(real time)?
2. Is it show the holiday data?

5-1-2. Stock Card export (xlsx) function

B

M

P

T

Sanko Mold and Plastics
(Thailand) Co., Ltd.

Stock Card Record TRT For 2023 July

No.	Part No.	Part Name	Unit	0000	0001	0002	0003	0004	0005	0006	0007	0008	0009	0010	0011	0012	0013	0014	0015	0016	0017	0018	0019	0020	0021	0022	0023	0024	0025	0026	0027	0028	0029	0030	0031	0032	0033	0034	0035	0036	0037	0038	0039	0040	0041	0042	0043	0044	0045	0046	0047	0048	0049	0050	0051	0052	0053	0054	0055	0056	0057	0058	0059	0060	0061	0062	0063	0064	0065	0066	0067	0068	0069	0070	0071	0072	0073	0074	0075	0076	0077	0078	0079	0080	0081	0082	0083	0084	0085	0086	0087	0088	0089	0090	0091	0092	0093	0094	0095	0096	0097	0098	0099	0100	0101	0102	0103	0104	0105	0106	0107	0108	0109	0110	0111	0112	0113	0114	0115	0116	0117	0118	0119	0120	0121	0122	0123	0124	0125	0126	0127	0128	0129	0130	0131	0132	0133	0134	0135	0136	0137	0138	0139	0140	0141	0142	0143	0144	0145	0146	0147	0148	0149	0150	0151	0152	0153	0154	0155	0156	0157	0158	0159	0160	0161	0162	0163	0164	0165	0166	0167	0168	0169	0170	0171	0172	0173	0174	0175	0176	0177	0178	0179	0180	0181	0182	0183	0184	0185	0186	0187	0188	0189	0190	0191	0192	0193	0194	0195	0196	0197	0198	0199	0200	0201	0202	0203	0204	0205	0206	0207	0208	0209	0210	0211	0212	0213	0214	0215	0216	0217	0218	0219	0220	0221	0222	0223	0224	0225	0226	0227	0228	0229	0230	0231	0232	0233	0234	0235	0236	0237	0238	0239	0240	0241	0242	0243	0244	0245	0246	0247	0248	0249	0250	0251	0252	0253	0254	0255	0256	0257	0258	0259	0260	0261	0262	0263	0264	0265	0266	0267	0268	0269	0270	0271	0272	0273	0274	0275	0276	0277	0278	0279	0280	0281	0282	0283	0284	0285	0286	0287	0288	0289	0290	0291	0292	0293	0294	0295	0296	0297	0298	0299	0300	0301	0302	0303	0304	0305	0306	0307	0308	0309	0310	0311	0312	0313	0314	0315	0316	0317	0318	0319	0320	0321	0322	0323	0324	0325	0326	0327	0328	0329	0330	0331	0332	0333	0334	0335	0336	0337	0338	0339	0340	0341	0342	0343	0344	0345	0346	0347	0348	0349	0350	0351	0352	0353	0354	0355	0356	0357	0358	0359	0360	0361	0362	0363	0364	0365	0366	0367	0368	0369	0370	0371	0372	0373	0374	0375	0376	0377	0378	0379	0380	0381	0382	0383	0384	0385	0386	0387	0388	0389	0390	0391	0392	0393	0394	0395	0396	0397	0398	0399	0400	0401	0402	0403	0404	0405	0406	0407	0408	0409	0410	0411	0412	0413	0414	0415	0416	0417	0418	0419	0420	0421	0422	0423	0424	0425	0426	0427	0428	0429	0430	0431	0432	0433	0434	0435	0436	0437	0438	0439	0440	0441	0442	0443	0444	0445	0446	0447	0448	0449	0450	0451	0452	0453	0454	0455	0456	0457	0458	0459	0460	0461	0462	0463	0464	0465	0466	0467	0468	0469	0470	0471	0472	0473	0474	0475	0476	0477	0478	0479	0480	0481	0482	0483	0484	0485	0486	0487	0488	0489	0490	0491	0492	0493	0494	0495	0496	0497	0498	0499	0500	0501	0502	0503	0504	0505	0506	0507	0508	0509	0510	0511	0512	0513	0514	0515	0516	0517	0518	0519	0520	0521	0522	0523	0524	0525	0526	0527	0528	0529	0530	0531	0532	0533	0534	0535	0536	0537	0538	0539	0540	0541	0542	0543	0544	0545	0546	0547	0548	0549	0550	0551	0552	0553	0554	0555	0556	0557	0558	0559	0560	0561	0562	0563	0564	0565	0566	0567	0568	0569	0570	0571	0572	0573	0574	0575	0576	0577	0578	0579	0580	0581	0582	0583	0584	0585	0586	0587	0588	0589	0590	0591	0592	0593	0594	0595	0596	0597	0598	0599	0600	0601	0602	0603	0604	0605	0606	0607	0608	0609	0610	0611	0612	0613	0614	0615	0616	0617	0618	0619	0620	0621	0622	0623	0624	0625	0626	0627	0628	0629	0630	0631	0632	0633	0634	0635	0636	0637	0638	0639	0640	0641	0642	0643	0644	0645	0646	0647	0648	0649	0650	0651	0652	0653	0654	0655	0656	0657	0658	0659	0660	0661	0662	0663	0664	0665	0666	0667	0668	0669	0670	0671	0672	0673	0674	0675	0676	0677	0678	0679	0680	0681	0682	0683	0684	0685	0686	0687	0688	0689	0690	0691	0692	0693	0694	0695	0696	0697	0698	0699	0700	0701	0702	0703	0704	0705	0706	0707	0708	0709	0710	0711	0712	0713	0714	0715	0716	0717	0718	0719	0720	0721	0722	0723	0724	0725	0726	0727	0728	0729	0730	0731	0732	0733	0734	0735	0736	0737	0738	0739	0740	0741	0742	0743	0744	0745	0746	0747	0748	0749	0750	0751	0752	0753	0754	0755	0756	0757	0758	0759	0760	0761	0762	0763	0764	0765	0766	0767	0768	0769	0770	0771	0772	0773	0774	0775	0776	0777	0778	0779	0780	0781	0782	0783	0784	0785	0786	0787	0788	0789	0790	0791	0792	0793	0794	0795	0796	0797	0798	0799	0800	0801	0802	0803	0804	0805	0806	0807	0808	0809	0810	0811	0812	0813	0814	0815	0816	0817	0818	0819	0820	0821	0822	0823	0824	0825	0826	0827	0828	0829	0830	0831	0832	0833	0834	0835	0836	0837	0838	0839	0840	0841	0842	0843	0844	0845	0846	0847	0848	0849	0850	0851	0852	0853	0854	0855	0856	0857	0858	0859	0860	0861	0862	0863	0864	0865	0866	0867	0868	0869	0870	0871	0872	0873	0874	0875	0876	0877	0878	0879	0880	0881	0882	0883	0884	0885	0886	0887	0888	0889	0890	0891	0892	0893	0894	0895	0896	0897	0898	0899	0900	0901	0902	0903	0904	0905	0906	0907	0908	0909	0910	0911	0912	0913	0914	0915	0916	0917	0918	0919	0920	0921	0922	0923	0924	0925	0926	0927	0928	0929	0930	0931	0932	0933	0934	0935	0936	0937	0938	0939	0940	0941	0942	0943	0944	0945	0946	0947	0948	0949	0950	0951	0952	0953	0954	0955	0956	0957	0958	0959	0960	0961	0962	0963	0964	0965	0966	0967	0968	0969	0970	0971	0972	0973	0974	0975	0976	0977	0978	0979	0980	0981	0982	0983	0984	0985	0986	0987	0988	0989	0990	0991	0992	0993	0994	0995	0996	0997	0998	0999	1000	1001	1002	1003	1004	1005	1006	1007	1008	1009	1010	1011	1012	1013	1014	1015	1016	1017	1018	1019	1020	1021	1022	1023	1024	1025	1026	1027	1028	1029	1030	1031	1032	1033	1034	1035	1036	1037	1038	1039	1040	1041	1042	1043	1044	1045	1046	1047	1048	1049	1050	1051	1052	1053	1054	1055	1056	1057	1058	1059	1060	1061	1062	1063	1064	1065	1066	1067	1068	1069	1070	1071	1072	1073	1074	1075	1076	1077	1078	1079	1080	1081	1082	1083	1084	1085	1086	1087	1088	1089	1090	1091	1092	1093	1094	1095	1096	1097	1098	1099	1100	1101	1102	1103	1104	1105	1106	1107	1108	1109	1110	1111	1112	1113	1114	1115	1116	1117	1118	1119	1120	1121	1122	1123	1124	1125	1126	1127	1128	1129	1130	1131	1132	1133	1134	1135	1136	1137	1138	1139	1140	1141	1142	1143	1144	1145	1146	1147	1148	1149	1150	1151	1152	1153	1154	1155	1156	1157	1158	1159	1160	1161	1162	1163	1164	1165	1166	1167	1168	1169	1170	1171	1172	1173	1174	1175	1176	1177	1178	1179	1180	1181	1182	1183	1184	1185	1186	1187	1188	1189	1190	1191	1192	1193	1194	1195	1196	1197	1198	1199	1200
-----	----------	-----------	------	------	------	------	------	------	------	------	------	------	------	------	------	------	------	------	------	------	------	------	------	------	------	------	------	------	------	------	------	------	------	------	------	------	------	------	------	------	------	------	------	------	------	------	------	------	------	------	------	------	------	------	------	------	------	------	------	------	------	------	------	------	------	------	------	------	------	------	------	------	------	------	------	------	------	------	------	------	------	------	------	------	------	------	------	------	------	------	------	------	------	------	------	------	------	------	------	------	------	------	------	------	------	------	------	------	------	------	------	------	------	------	------	------	------	------	------	------	------	------	------	------	------	------	------	------	------	------	------	------	------	------	------	------	------	------	------	------	------	------	------	------	------	------	------	------	------	------	------	------	------	------	------	------	------	------	------	------	------	------	------	------	------	------	------	------	------	------	------	------	------	------	------	------	------	------	------	------	------	------	------	------	------	------	------	------	------	------	------	------	------	------	------	------	------	------	------	------	------	------	------	------	------	------	------	------	------	------	------	------	------	------	------	------	------	------	------	------	------	------	------	------	------	------	------	------	------	------	------	------	------	------	------	------	------	------	------	------	------	------	------	------	------	------	------	------	------	------	------	------	------	------	------	------	------	------	------	------	------	------	------	------	------	------	------	------	------	------	------	------	------	------	------	------	------	------	------	------	------	------	------	------	------	------	------	------	------	------	------	------	------	------	------	------	------	------	------	------	------	------	------	------	------	------	------	------	------	------	------	------	------	------	------	------	------	------	------	------	------	------	------	------	------	------	------	------	------	------	------	------	------	------	------	------	------	------	------	------	------	------	------	------	------	------	------	------	------	------	------	------	------	------	------	------	------	------	------	------	------	------	------	------	------	------	------	------	------	------	------	------	------	------	------	------	------	------	------	------	------	------	------	------	------	------	------	------	------	------	------	------	------	------	------	------	------	------	------	------	------	------	------	------	------	------	------	------	------	------	------	------	------	------	------	------	------	------	------	------	------	------	------	------	------	------	------	------	------	------	------	------	------	------	------	------	------	------	------	------	------	------	------	------	------	------	------	------	------	------	------	------	------	------	------	------	------	------	------	------	------	------	------	------	------	------	------	------	------	------	------	------	------	------	------	------	------	------	------	------	------	------	------	------	------	------	------	------	------	------	------	------	------	------	------	------	------	------	------	------	------	------	------	------	------	------	------	------	------	------	------	------	------	------	------	------	------	------	------	------	------	------	------	------	------	------	------	------	------	------	------	------	------	------	------	------	------	------	------	------	------	------	------	------	------	------	------	------	------	------	------	------	------	------	------	------	------	------	------	------	------	------	------	------	------	------	------	------	------	------	------	------	------	------	------	------	------	------	------	------	------	------	------	------	------	------	------	------	------	------	------	------	------	------	------	------	------	------	------	------	------	------	------	------	------	------	------	------	------	------	------	------	------	------	------	------	------	------	------	------	------	------	------	------	------	------	------	------	------	------	------	------	------	------	------	------	------	------	------	------	------	------	------	------	------	------	------	------	------	------	------	------	------	------	------	------	------	------	------	------	------	------	------	------	------	------	------	------	------	------	------	------	------	------	------	------	------	------	------	------	------	------	------	------	------	------	------	------	------	------	------	------	------	------	------	------	------	------	------	------	------	------	------	------	------	------	------	------	------	------	------	------	------	------	------	------	------	------	------	------	------	------	------	------	------	------	------	------	------	------	------	------	------	------	------	------	------	------	------	------	------	------	------	------	------	------	------	------	------	------	------	------	------	------	------	------	------	------	------	------	------	------	------	------	------	------	------	------	------	------	------	------	------	------	------	------	------	------	------	------	------	------	------	------	------	------	------	------	------	------	------	------	------	------	------	------	------	------	------	------	------	------	------	------	------	------	------	------	------	------	------	------	------	------	------	------	------	------	------	------	------	------	------	------	------	------	------	------	------	------	------	------	------	------	------	------	------	------	------	------	------	------	------	------	------	------	------	------	------	------	------	------	------	------	------	------	------	------	------	------	------	------	------	------	------	------	------	------	------	------	------	------	------	------	------	------	------	------	------	------	------	------	------	------	------	------	------	------	------	------	------	------	------	------	------	------	------	------	------	------	------	------	------	------	------	------	------	------	------	------	------	------	------	------	------	------	------	------	------	------	------	------	------	------	------	------	------	------	------	------	------	------	------	------	------	------	------	------	------	------	------	------	------	------	------	------	------	------	------	------	------	------	------	------	------	------	------	------	------	------	------	------	------	------	------	------	------	------	------	------	------	------	------	------	------	------	------	------	------	------	------	------	------	------	------	------	------	------	------	------	------	------	------	------	------	------	------	------	------	------	------	------	------	------	------	------	------	------	------	------	------	------	------	------	------	------	------	------	------	------	------	------	------	------	------	------	------	------	------	------	------	------	------	------	------	------	------	------	------	------	------	------	------	------	------	------	------	------	------	------	------	------	------	------	------	------	------	------	------	------	------	------	------	------	------	------	------	------	------	------	------	------	------	------	------	------	------	------	------	------	------	------	------	------	------	------	------	------	------	------	------	------	------	------	------	------	------	------	------	------	------	------	------	------	------	------	------	------	------	------	------	------	------	------	------	------	------	------	------	------	------	------	------	------	------	------	------	------	------	------	------	------	------	------	------	------	------	------	------	------	------	------	------	------	------	------	------	------	------	------	------	------	------	------	------	------	------	------	------	------	------	------	------	------	------	------	------	------	------	------	------	------	------	------	------	------	------	------	------	------	------	------	------	------	------	------	------	------	------	------	------	------	------	------	------	------	------	------	------	------	------	------	------	------

5. Configuration file storage

Display data:



5-2-1. Stock control vision monitor



Sanko Mold and Plastics
(Thailand) Co., Ltd.



☐ Automatic mode

Finish Goods Delivery Condition & Stock Control Vision

No.	Part no	Name	Forecast	Maximum	Minimum	Status of delivery															Current Stock	Day Forecast
						1	2	3	4	5	6	7	8	9	10	11	12	13	14	15		
1	abc123-001	item name 001	13846	1384	4615	●															391	461
2	abc123-002	item name 002	16086	1608	5362															●	13238	536
3	abc123-003	item name 003	91722	9172	30574				●												13229	3057
4	abc123-004	item name 004	10452	1045	3484											●					4101	348
5	abc123-005	item name 005	19103	1910	6367					●											3282	636
6	abc123-006	item name 006	3860	386	1286			●													452	128
7	abc123-007	item name 007	2784	278	928														●		1355	92
8	abc123-008	item name 008	96293	9629	32097								●								27934	3209
9	abc123-009	item name 009	58288	5828	19429														●		46619	1942
10	abc123-010	item name 010	8215	821	2738														●		8206	273
11	abc123-011	item name 011	7671	767	2557					●											1496	255
12	abc123-012	item name 012	25017	2501	8339	●															176	833
13	abc123-013	item name 013	26510	2651	8836														●		21411	883
14	abc123-014	item name 014	241199	24119	80399								●								66108	8039
15	abc123-015	item name 015	8739	873	2913														●		4182	291
16	abc123-016	item name 016	13183	1318	4394														●		6511	439
17	abc123-017	item name 017	1932	193	644					●											396	64
18	abc123-018	item name 018	19139	1913	6379								●								5736	637
19	abc123-019	item name 019	41545	4154	13848														●		26185	1384
20	abc123-020	item name 020	1650	165	550	●															40	55
21	abc123-021	item name 021	11556	1155	3852					●											2426	385
22	abc123-022	item name 022	5476	547	1825					●											1110	182
23	abc123-023	item name 023	1953	195	651														●		1321	65
24	abc123-024	item name 024	35191	3519	11730														●		25817	1173

Display filter & settings function.

- Show the current month data.
- Choose the customer manually or automatic change.
- Auto mode enable/disable.
- Define the display time interval.
- Automatic vertical scroll or disable.

5. Configuration file storage

20/Sep/2023 Additional corrections



Simple Inbound

User : Ryo Nozaki

Cust All

Inbound date 30/04/2021

#	Parts no	Cust	Box	Qty	Status
1	C12345-199	TRT	2	400	<
2	C12345-199	RICA	1	150	OK
3	C12345-200	TRT	5	1500	-

F1 Menu F4 Confirm

Simple Inbound

User : Ryo Nozaki

TRT

Inbound date 30/04/2021

#	Parts no	Cust	Box	Qty	Status
1	C12345-199	TRT	2	400	OK
2	C12345-200	TRT	5	1500	-

F1 Menu F4 Confirm

refer to data on a handy terminal
[Simple inbound and outbound]
Select Customer for group

Simple Outbound

User : Ryo Nozaki

Cust All

Outbound date 30/04/2021

#	Parts no	Cust	Box	Qty	Status
1	C12345-199	TRT	2	400	<
2	C12345-199	RICA	1	150	OK
3	C12345-200	TRT	5	1500	-

F1 Menu F4 Confirm

Simple Outbound

User : Ryo Nozaki

TRT

Outbound date 30/04/2021

#	Parts no	Cust	Box	Qty	Status
1	C12345-199	TRT	2	400	OK
2	C12345-200	TRT	5	1500	-

F1 Menu F4 Confirm

refer to data on a handy
terminal [Simple inbound and
outbound]
Select Customer for group

5. Configuration file storage

20/Sep/2023 Additional corrections

6

Customer : (TRT) Taka Rika

Search

Clear

Month : September

Year : 2023

Stock Card Record TRT For 2023 September

No.	Parts No.	Parts name	Pcs/Box	Balance (End of Month)	Date	1/09	2/09	3/09	4/09	5/09	6/09	7/09	8/09	9/09	10/09	11/09	12/09	13/09	14/09	15/09	16/09	17/09	18/09	19/09	20/09	21/09
1	15D212-0040A	LIGHT GUIDE	1200	BOX	PCS	IN																				
				0	0	OUT																				
				Balance																						
2	15F807-0030	HOLDER	200	BOX	PCS	IN																				
				0	0	OUT																				
				Balance																						
3	15G334-0030B	BODY UPR	500	BOX	PCS	IN																				
				0	0	OUT																				
				Balance																						
4	15G334-0081	COVER	100	BOX	PCS	IN																				
				0	0	OUT																				
				Balance																						
5	15G638-0020	COVER	100	BOX	PCS	IN																				
				0	0	OUT																				
				Balance																						

					12	2400								7	1400	43	8600									
S	BOX	PCS	BOX	PCS	BOX	PCS	BOX	PCS	BOX	PCS	BOX	PCS	BOX	PCS	BOX	PCS	BOX	PCS	BOX	PCS	BOX	PCS	BOX	PCS	BOX	PCS
					33		0							0		28										
					0		12							7		5										
					33	16500	21	10500	21	10500	21	10500	14	7000	37	18500										
S	BOX	PCS	BOX	PCS	BOX	PCS	BOX	PCS	BOX	PCS	BOX	PCS	BOX	PCS	BOX	PCS	BOX	PCS	BOX	PCS	BOX	PCS	BOX	PCS	BOX	PCS
					31		50							30												
					0		62							31												
					31	3100	19	1900	19	1900	19	1900	18	1800												
S	BOX	PCS	BOX	PCS	BOX	PCS	BOX	PCS	BOX	PCS	BOX	PCS	BOX	PCS	BOX	PCS	BOX	PCS	BOX	PCS	BOX	PCS	BOX	PCS	BOX	PCS
					8									0		0										
					0									1		1										
					8	800	8	800	8	800	8	800	7	700	6	600										

Even for dates that have not been updated, the information on the stock card will be reflected as Balance the day before

6. Web config

Master data: 2

6-1. Calendar

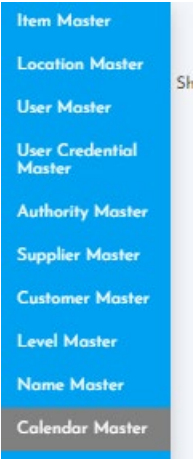

Calendar Master

Version 0.1

Date Range

select a date

select a date

Search

Date

CSV Import

CSV Export

Delete

Search

Clear

Show10entries

6-2. Forecast master & Standard packing master 3

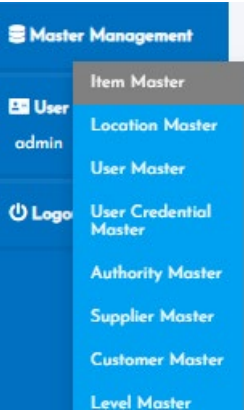

Item Master

Item code : 15540-640-A000

15700-06005-08

Search

CSV Import

CSV Export

Delete

Search

Clear

Show 10 entries

#	Item code	Item name	Division	Name code	Ordering point	Safety stock	Unit price	Target Inventory Turnover	Fixed Location	Storage Type	Pick Assy	Remark	Image	Period From	Period To
1	15540-640-A000	PIPE COMP T/C OIL RETURN	1	0	0	0	100	0.00	TAY1-A-3F-1	Rack	Once				
2	15540-640-A0005-5a3	PIPE COMP T/C OIL RETURN	1	0	0	0	100	0.00	TAY3-B-3F-3	DPS	Once				
3	15540-640-A010-M2	HOSE T/C OIL RETURN	1	0	0	0	100	0.00	TAY1-A-3F-2	Rack	Once				
4	15540-640-A010-M2(5a3)	HOSE T/C OIL RETURN	1	0	0	0	100	0.00	TAY1-C-3F-2	Rack	Once				
5	15544-598-0032	GSKT T/C OIL RETURN PIPE	1	0	0	0	100	0.00	TAY3-B-3F-4	DPS	Once				
6	16400-598-0033	ELECTRONIC CONTL THROTLERBODY	1	0	0	0	100	0.00	TAY3-B-3F-4	DPS	Once				
7	16400-64C-T010-M1	ELECTRONIC CONTL THROTLERBODY	1	0	0	0	100	0.00	TAY3-S-3F-4	DPS	Once				
8	17000-64D-P000	MANIFOLD ASSY INT	1	0	0	0	100	0.00	TAY2-A-1F-1	Dully	Once				
9	17000-64A-0040	MANIFOLD COMP INT	1	0	0	0	100	0.00	TAY2-A-1F-2	Dully	Once				
10	1700A-64A-0000	MANIFOLD ASSY IN	1	0	0	0	100	0.00	FG-A-1	Dully	Box				

Showing 1 to 10 of 108 entries

First

Previous

1

2

3

4

5

...

10

Next

Last

Additional columns

- Forecast number (separated on each month)
- Standard packing size (may different for each customer)

7. Q&A

8. Sign off

We hereby acknowledge and agree the above-mentioned blueprint requirements.
Any changes required after the sign off for this blueprint will be addressed through the change request process.

Sanko Mold and Plastics (Thailand) Co.,Ltd.

Sign: _____

Name: _____

Title: _____

Date: _____

TOMAS TECH CO.,LTD.

Sign: _____

Name: _____

Title: _____

Date: _____

END OF BLUEPRINT##